

座 標 求 積 表

地番	宅地1		
測点	Xn	Yn	(Xn+1 - Xn-1)Yn
DK2	-15149.207	-25688.276	-382524.117916
BP1	-15147.081	-25674.828	329844.515316
BP2	-15162.054	-25672.461	436637.216688
B21	-15164.089	-25685.372	-2106.200504
DP8	-15161.972	-25685.785	-382255.852370
		倍面積	-404.438786
		面積	202.2193930
		地積	202.21 m ²
		坪数	61.17

地番	宅地2		
測点	Xn	Yn	(Xn+1 - Xn-1)Yn
BP1	-15147.081	-25674.828	-385584.566904
DP6	-15147.036	-25674.539	-54584.069914
DK4	-15144.955	-25661.380	284584.704200
DK7	-15158.126	-25659.548	385432.070508
B22	-15159.976	-25659.290	100789.691120
BP2	-15162.054	-25672.461	-331046.384595
		倍面積	-408.555585
		面積	204.2777925
		地積	204.27 m ²
		坪数	61.79

地番	宅地3		
測点	Xn	Yn	(Xn+1 - Xn-1)Yn
DP11	-15186.009	-25701.849	-46186.222653
DK10	-15185.375	-25699.031	-56023.887580
BP4	-15183.829	-25692.083	407887.509708
BP3	-15201.251	-25688.258	500047.630228
43302-19	-15203.295	-25693.572	108760.890276
DK18	-15205.484	-25699.134	-414347.137482
DP12	-15187.172	-25701.728	-500541.152800
		倍面積	-402.370303
		面積	201.1851515
		地積	201.18 m ²
		坪数	60.85

地番	宅地4		
測点	Xn	Yn	(Xn+1 - Xn-1)Yn
BP4	-15183.829	-25692.083	-505491.733025
DP9	-15181.576	-25681.961	-63793.991124
BP6	-15181.345	-25680.922	404140.669514
BP5	-15197.313	-25677.528	410840.448000
43301-3	-15197.345	-25677.620	11734.672340
DK19	-15197.770	-25678.802	43499.890588
43302-21	-15199.039	-25682.326	86498.073968
43302-20	-15201.138	-25687.965	56821.778580
BP3	-15201.251	-25688.258	-444638.057722
		倍面積	-388.248881
		面積	194.1244405
		地積	194.12 m ²
		坪数	58.72

地番	宅地5		
測点	Xn	Yn	(Xn+1 - Xn-1)Yn
BP6	-15181.345	-25680.922	-474095.501042
BP8	-15178.852	-25669.722	313221.947844
BP7	-15193.547	-25666.474	415745.545852
43301-4	-15195.050	-25670.981	96676.914446
BP5	-15197.313	-25677.528	-351910.521240
		倍面積	-361.614140
		面積	180.8070700
		地積	180.80 m ²
		坪数	54.69

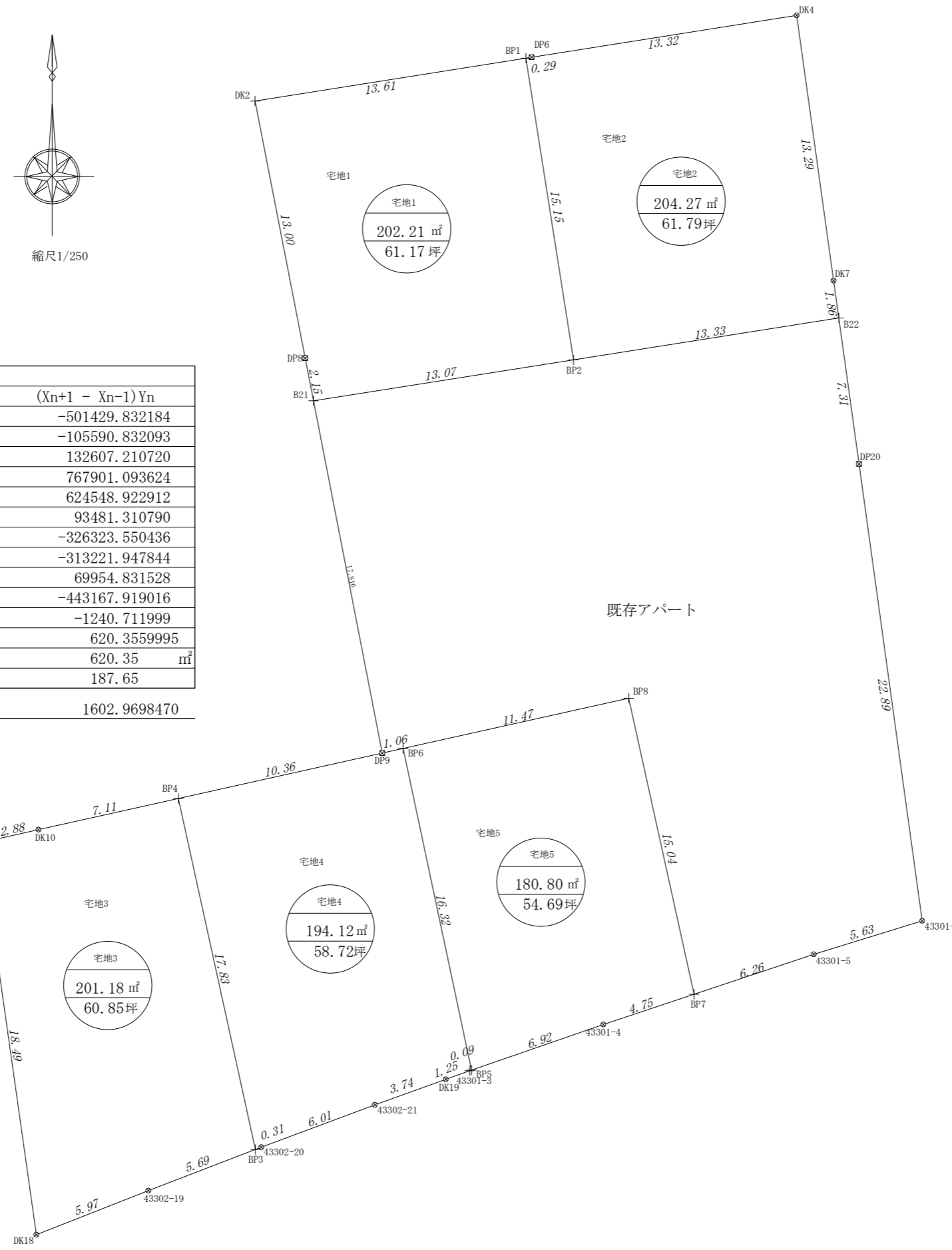

地番	既存アパート		
測点	Xn	Yn	(Xn+1 - Xn-1)Yn
B21	-15164.089	-25685.372	-501429.832184
BP2	-15162.054	-25672.461	-105590.832093
B22	-15159.976	-25659.290	132607.210720
DP20	-15167.222	-25658.283	767901.093624
43301-6	-15189.904	-25655.148	624548.922912
43301-5	-15191.566	-25660.530	93481.310790
BP7	-15193.547	-25666.474	-326323.550436
BP8	-15178.852	-25669.722	-313221.947844
BP6	-15181.345	-25680.922	69954.831528
DP9	-15181.576	-25681.961	-443167.919016
		倍面積	-1240.711999
		面積	620.3559995
		地積	620.35 m ²
		坪数	187.65
合計			1602.9698470